

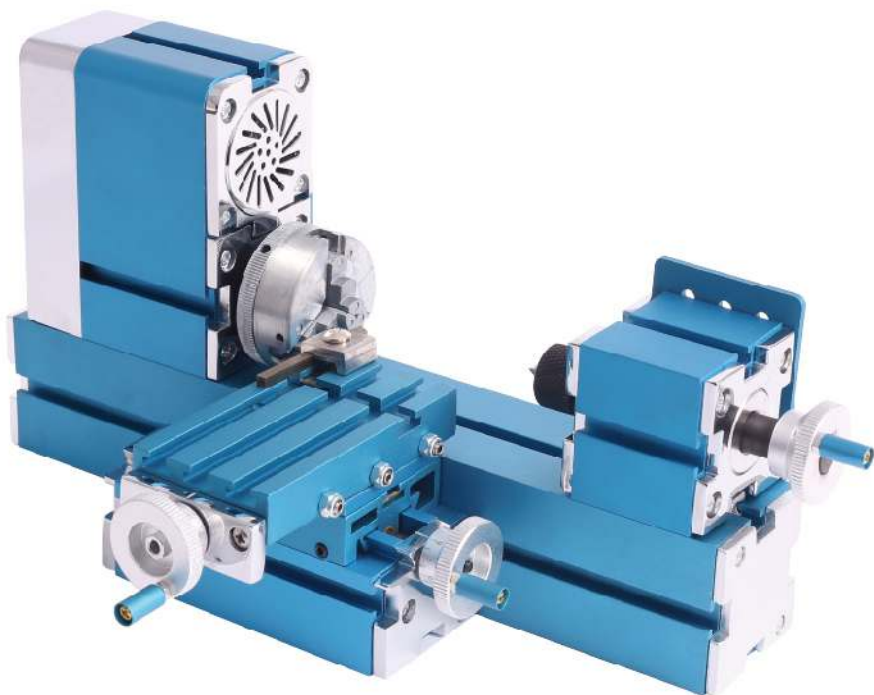

万能金属机床系列说明书

MINI METAL MACHINE
USER MANUAL



W103MA/MB/MC
万能金属车床
Metal Lathe

感谢您选购先导万能机床，先导万能机床是针对青少年和模型爱好者设计的一种微型机械加工设备。本产品是一种益智、创客工具类产品。它有助于培养和提高操作者的动手能力、独立思考能力，助力有理想的创客实现自己的想法。

Thank you for choosing XENDOLL multipurpose machines, which are designed for teenagers and DIY hobbyist. It not only helps to cultivate, improve the operational ability and independent thinking, but also inspire operators to achieve their dreams.

致客户/用户 To Customers

为了保障您的安全和健康，请在使用机器前，仔细阅读本说明书。本手册包含机床图解、操作方法、维护清洁、故障排查等，正确的方法会使你的操作更顺畅。

Please read the instruction carefully before using the product. It shows you the whole procedures of operation, maintenance, inspection and cleaning. Further cautions and warning can be found on each machine's operation instruction. Proper operation will make your experience more easier.

安全注意事项 General Caution And Warning

- 保持工作区域干净，不要在脏乱、潮湿的环境下工作。为了您的健康，工作室应通风良好；
Keep the working area clean and dry. Do not work under dirty and wet environment. We highly recommend working in a dust free environment with sufficient airing.
- 少年儿童需在成人陪同下使用；
Children use the machine under supervision of adults.
- 不使用时机器应储存在孩子无法自由取用的地方；
Keep the machine out of reach of children.

- 操作时应佩戴好护目镜，保护您的眼睛；
Always wear goggles to protect your eyes when operating the machine.
- 露在外面的衣服（衣袖）或头发应束好，不可靠近旋转物件，以免卷入弄伤；
Keep your hair and clothing away from the moving parts.
- 机器运转时如有异响应立即停机检查，查明原因并修复后再开机继续使用；
Stop the machine immediately when anomalous sound is heard, use it after the issue was found and fixed.
- 经常检查部件是否有损坏，若有损坏应立即替换或维修被损坏或磨损部分。由于先导机床一些零部件有特殊设计，建议使用原厂零部件，如因使用非原厂零部件而引起不良后果，我司不予负责；
Always check the machine before operation, shift or replace the worn parts if required. As some of the components are designed specially for the machine, you are advised to use our components avoiding injury and to extend the life span of your machine.
- 保持工作室的清洁，油脂、余料及其他杂物需及时清理，工作室内不宜储存易燃、易爆及化学用品；
Keep away from chemicals and explosives.
- 本手册不包括全部可能发生的情况和操作，了解常识和小心最安全；
Our manual has not covered all the conditions that you may confront. Please always operate with caution.
- 由于产品升级换代，图片可能与实物有差别，请以实物为准，敬请留意！
Due to irregular upgrading of product, the image/pictures shown in the manual are for reference only.

1. 技术参数 Technical Parameter

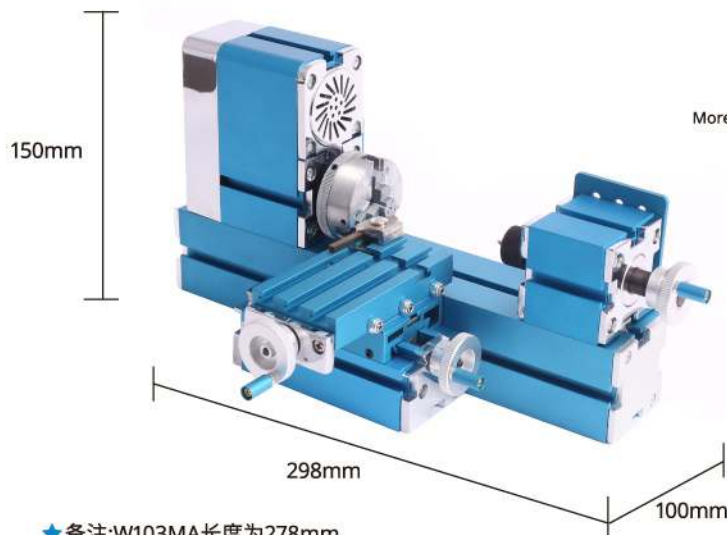

More videos on YouTube

★备注:W103MA长度为278mm

输入电压 Input Voltage	/	AC 100V-240V 50/60HZ
输出电压 Output Voltage	/	DC 12V
电流 Direct Current	/	4A
电机转速 Motor Speed	r/min	20000±15%
主轴转速 Spindle Speed	r/min	3000±15%
主轴通孔 Spindle Bore	mm	8
中心距 Distance Between Centers	mm	110 (选配特长机座可增加至330) (Optional: Extra long machine bed for 330)
中心高 Center Height	mm	25 (选配中间块可增加至45) (Optional: Intermediate block for center height up to 45)
最大装夹直径 Chuck Diameter	mm	正爪13/反爪45 Positive claw:13 / Reverse claw: 45
白钢刀车刀 Cutting Tool	mm	3.5x3.5
手柄刻度 Handle Scale	mm	0.1 /frame
包装尺寸 Packing Size	mm	330x210x240

2. 部件清单 Part List



W003

主轴箱 Headstock



W021

皮带轮罩 Drive Belt Cover



W013

大滑块组件 Large Slide



W017

小滑块组件(Y轴)
Y Axis Cross Slide



W011

长机座 Machine Bed, Long



W016

顶尾座 Tailstock

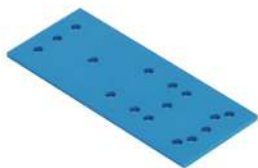

W009

加强板 Reinforcing Plate



W005

连接块 Connection Piece



W031

旋转顶尖 Live Center



W043

外圆车刀 Cutting Tool



W054

三爪自定心卡盘 Three-jaw Chuck

3. 随机配件清单 Accessories



型号 S.N	部件名称 Parts	规格 Spec.
W001	单头开关电源 Power Adapter	12V 4A
W055	薄款双头扳手 Open End Wrench	/
W038	内六角扳手 HEX Wrench	S=2
W039	内六角扳手 HEX Wrench	S=2.5
W048	中心测量尺 Center Finder	/
W030	三爪盘锁紧杆 3-jaw Chuck Key	/
W069	垫片 Spacer	0.3
W070	垫片 Spacer	0.4
W029	双孔槽螺母 Slot Nut-double Hole	/
W095	十字大扁头机丝螺钉 Screw	M4X16
W057	十字小号螺丝刀 Screwdriver	L=128X3.0
W058	十字中号螺丝刀 Screwdriver	L=190X4.0
W096	围裙 Apron	/
W097	护目镜 Goggle	/

4. 安装图 Installation Diagram



Step 02.
大滑块与小滑块组件安装。

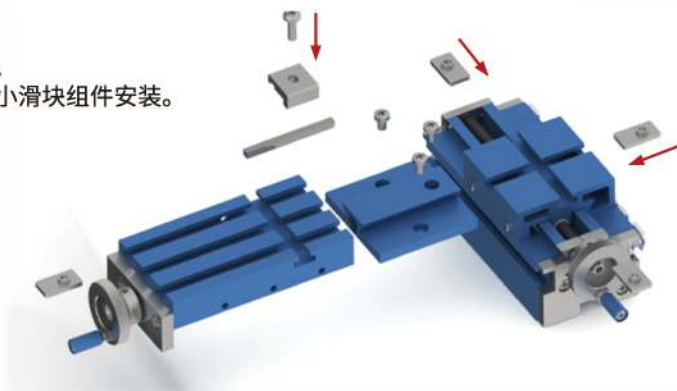

Step 03.
整机连接安装。



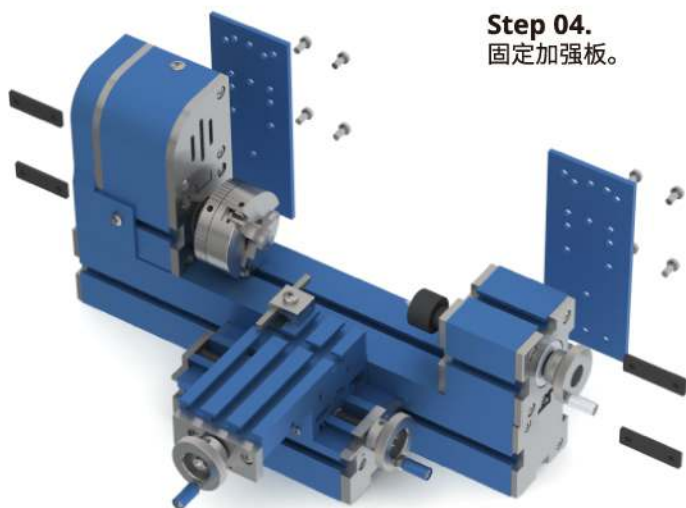

Step 04.
固定加强板。

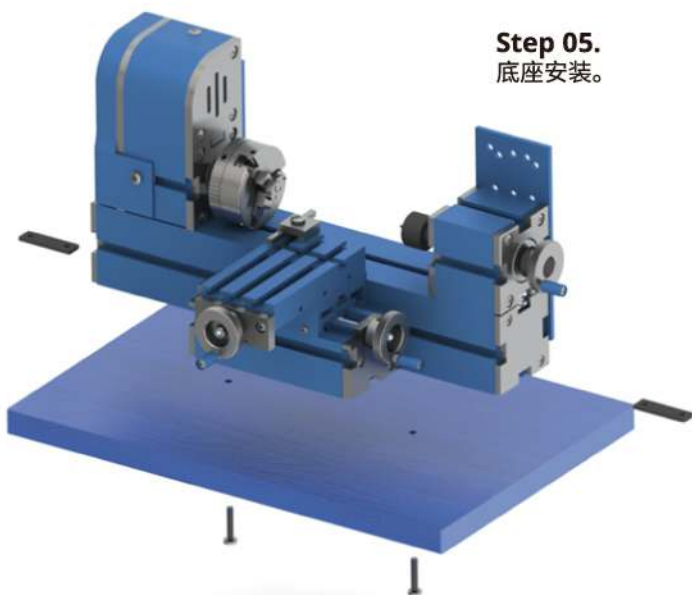

Step 05.
底座安装。

5.使用须知 General Operation Cautions

- 使用机床前，请检查机器零部件是否接触良好，防止运输过程中可能造成部分零件松散。

Please make sure all the parts of machine are tightened before all the operations.

- 使用前，根据加工工件直径的大小确定三爪卡盘夹紧方式，根据工件长度调整顶尾座与主轴箱之间的距离并固定（工字连接块+加强板）。

According to the diameter and length of workpiece, choose positive or reverse claw and adjust the distance between chuck and tail stock.

- 根据加工工件直径调整刀具伸出长度，并夹紧。车刀刀尖点高度可通过垫片调整至合适高度（与主轴中心线在同一水平面上）。

Adjust the height of tool to aligned the workpiece.

- 加工前必须用三爪卡盘夹紧工件，并用顶尾座上的旋转顶尖顶住工件尾部端面中心，最后锁紧顶尾座螺杆上的螺母（避免加工中震动致工件松脱）。

Make sure the workpiece is centers-aligned between the chuck and tailstock.

- 夹持大直径（直径大于40mm）工件时，请使用专用的中间块把主轴箱、顶尾座、小滑块升高，再把三爪卡盘的三爪倒转方向，使用反爪夹持。

Use reverser claw if the diameter of workpiece is more than 40mm, and adding connection block for heighten the headstock, tailstock and slide.

- 当大滑块的行程不能满足加工需要时，请调整大滑块固定在长机座的左右位置。

Moving the slide left or right for better feeding.

- 加工时出现噪声过大或皮带松脱时，请关闭电源后调整皮带松紧度。
Turn off the machine for driver belt adjustment if the machine is too chatters.
- 加工时，请勿用手触碰旋转部件；避免衣服和头发接触旋转部件；使用时应佩戴护目镜。
Never touch the rotating parts. Keep hair and loose cloths away from the machine. Always wear goggle while working.
- 使用时，因阻力过大，导致主轴不转或速度明显减慢时，请在三秒内移开阻力或切断电源，以免烧毁电源，查明原因并解决问题，再启动机器。
Cut the power off immediately if the headstock is too hot or stop running. Please refer to the problem solutions before restart the machine again.
- 使用完毕，先关闭开关，再拔出电源。
Always turn off the machine before unplugging the power cord.

6. 皮带松紧调节方法 How To Adjust The Belt

W103MA系列主轴箱：

用十字螺丝刀调节主轴箱上的皮带调节螺钉，朝顺时针方向拧为拉紧皮带，朝逆时针方向拧为调松皮带。调整螺钉后请将螺钉头朝下压一下以消除螺钉虚位。
Use the Phillips screwdriver to adjust the screw on the headstock. Clockwise tighten and counter clockwise loosen (As shown in the figure).

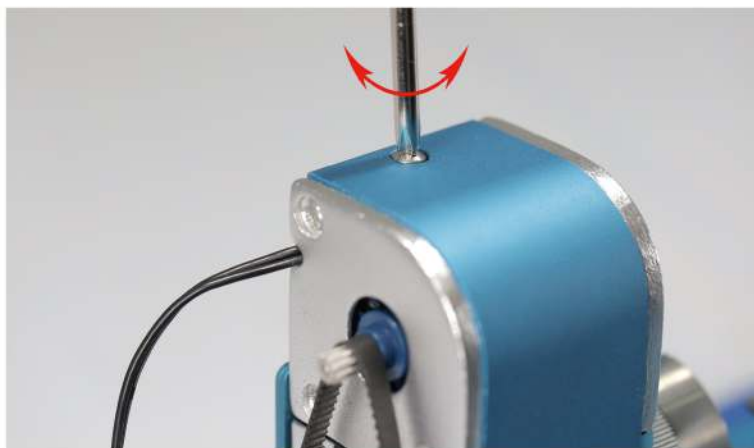

用手压下皮带，皮带压下量为3至5mm时皮带松紧度适宜。
To check the tightness of the drive belt as shown in the figure.

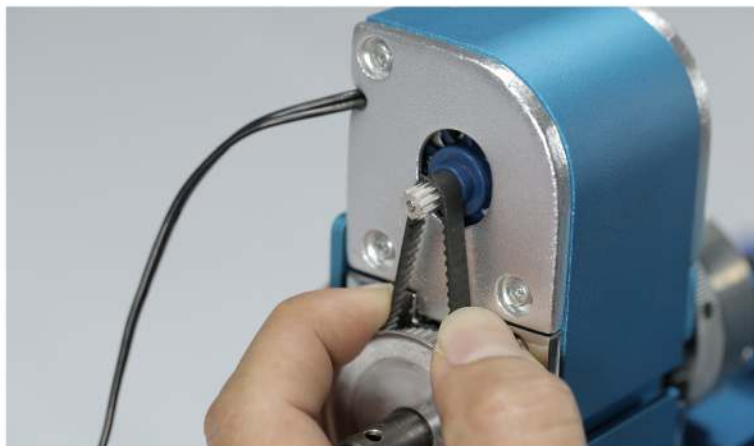

W103MB/MC系列主轴箱：

松开皮带轮罩
Take off the
belt cover



松开固定块上
两个螺丝
Loosen the
screw



调松紧皮带

Adjust the screw on the top, clockwise tighten and counter clockwise loosen
(As shown in the figure).

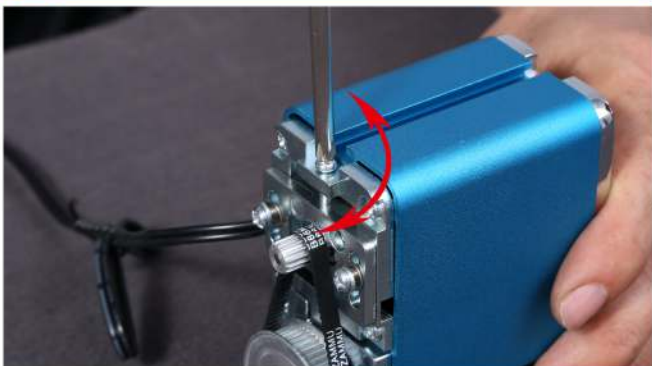

用手压下皮带，皮带压下量为3至5mm时皮带松紧度适宜，然后拧紧电机固定块上的两颗螺丝后把皮带轮罩安装上即可。

To check the tightness of the drive belt as shown in the figure, retighten the screw and put the belt cover on.

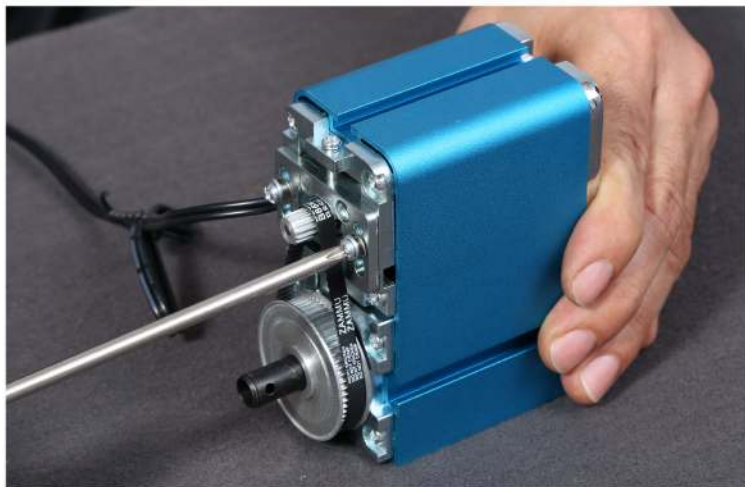

7.零件圆心定位方法 How To Assemble The Workpiece

使用中心测量尺沿着零件的直径画取两根直线，直线交汇处即是零件的圆心，木棒两头同样操作，把顶尾座上的旋转顶尖对准后顶紧。

Center finder: measure the center of round workpiece. Use the center measuring ruler to draw two straight lines along the diameter of the part, and the intersection of the straight lines is the center point of the part. Operate the two ends of the wooden rod in the same way, and align the rotating center on the top and tail seat and tighten it.

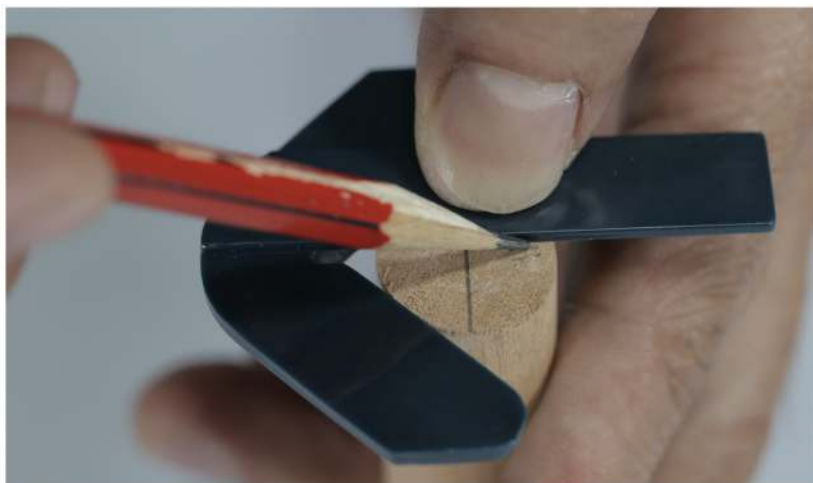

8. 连接块的摆放 How To Assemble The Connection Piece

连接块间相互错开放置（如图所示），螺丝头朝外侧。安装时，连接块的厚截面向上，它的朝向（上下朝向）须朝向需要移动部件一侧。

Put each piece contrary to the others (as shown in the figure), the head of the screw faces outward. Each piece's inclined plane faces inward with the other one.

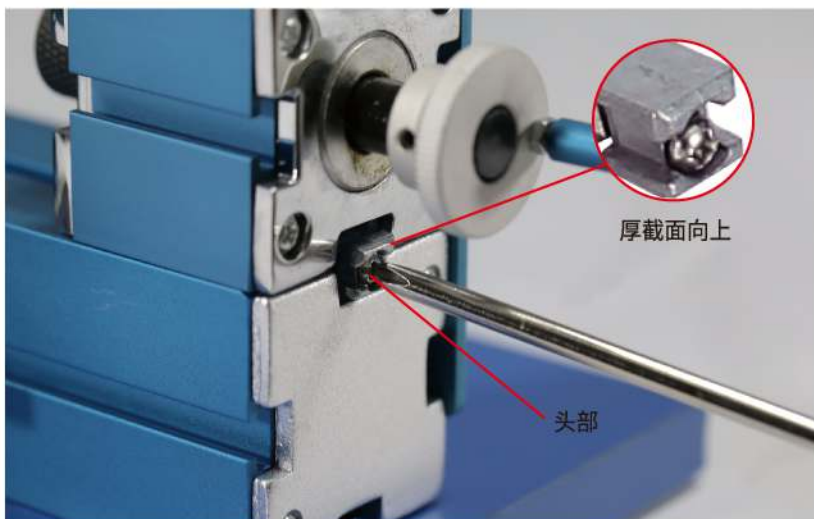

9.三爪卡盘的使用 How To Use Three-jaw Chuck

如图所示，把三爪盘锁紧铁杆插入三爪卡盘的小孔内，旋转三爪卡盘锁紧铁杆将三爪打开或合拢。旋转夹盘直至三爪被推出，调换三爪的方向可以改变三爪卡盘夹紧工件的最大尺寸。

注意：安装三爪卡盘时卡爪号码与盘面号码应一一对应，三爪在安装时应按1、2、3的次序旋入，并注意导轨的方向，小直径工件使用正爪，大直径工件使用反爪。

For the original 3-jaw chuck that mounted on the lathe, the factory has mounted the chuck in the best way to guarantee the holding accuracy. To lock and loose the chuck by using chuck key. Positive Claw:0-10mm, Reverse Claw:10-40mm.

Pick the right claw according to the diameter of workpiece.

Attention: Please note that the number of jaws fit with the number inside the chuck's groove. Do not mix them together. When you are going to mount them, please mount them in ascending order 1-2-3, when you are going to take them out, be sure in the descending order 3-2-1, one by one. After you finished this procedure, rotate the jaws to the smallest diameter and check that the three jaws are well-fitted.

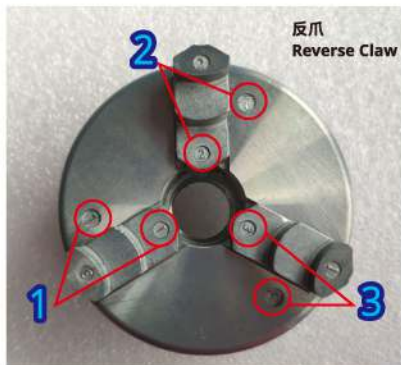
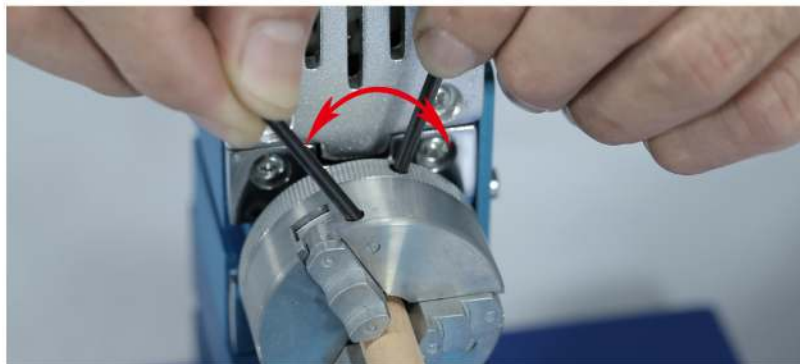

10. 滑块配合松紧度调节方法 How To Adjust The Slide

移动滑块时感觉到左右窜动的时候，可以通过调节滑块的燕尾松紧来进行修理，滑块燕尾配合松动可用内六角扳手调节滑块上的各个紧定螺丝进行调节，各个紧定螺丝须均匀调节。

To adjust the slide, adjust the set screws and the lock nuts on the side which shown in the picture below. If the adjustment is too tight, the slide will moves with difficulty. Loosen the lock nuts and tighten the set screws until slide moves freely with out play .Tighten lock nuts to retain adjustment.

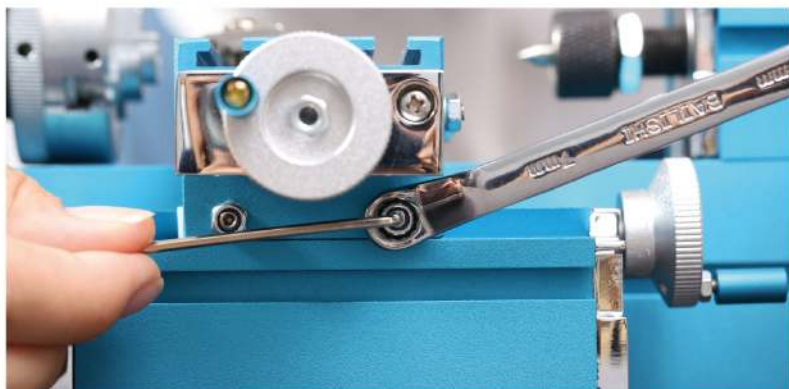

11. 装夹大直径工件方法 Method For Assembling Large Diameter Workpiece

加装中间块后，车床主轴中心高度可增至45mm。

(中间块不包含在本产品，有需要请联系售后服务购买)

After assembling the intermediate connection piece, the center height can be added up to 45mm. (The Intermediate Connection Piece is not included in this package contact us for purchase).



12. 常见故障处理 Problem Solution

故障现象 Problems	原因分析 Possible cause	故障现象 Solution
通电后主轴不转 Headstock is not working	电源适配器无输出 Adapter is broken	更换电源 Replace adapter
	主轴卡滞 Spindle is broken	更换主轴轴承 Bearing loosen or worn
	皮带脱开 Drive belt is off the motor	安装皮带并调整松紧 Reload the belt and adjusted

故障现象 Problems	原因分析 Possible cause	故障现象 Solution
运转噪声过大 Abnormal sounds and noise	各部件连接松动 Loose parts	紧固各部件 Tighten the parts
	皮带过松/过紧 The belt is too loose / too tight	调整皮带松紧度 Adjust the tightness of the belt
滑块运动困难 Slider moves with difficulty	滑块螺杆木屑堆积 Chips blocking sliding way	清理木屑，并加润滑油 Clean and lubricate with oil
	滑块紧定螺丝调节过紧 Set screw is too tight on the slide	调节紧定螺丝松紧度 Adjust the tightness
加工不顺畅 Operation issue	加工吃刀量过大 Feed too high	根据工件材质调整吃刀量 Reduce feeding speed
	刀尖未对准主轴中心高 Tool tip is not positioned at the rotation center of workpiece	用垫片调整刀尖高度 Adjust the high of tool tip
	车刀不锋利 Tool blunt	修整刀具 Use shape tool
	工件未夹紧或装夹偏心 Workpiece off center or mount	重新装夹工件 Remount the workpiece

保修卡

尊敬的用户：

感谢您购买并用本产品，为了使我们的服务让您满意，购买后请认真阅读此保修卡并妥善保存。

一、此保修卡为质保凭证，必须加盖厂家或经销商的印章才有效。

二、免费保修期为一年，自保修卡上注明日期开始计算。

丝杆	轴承	主轴箱
大小滑块	开关电源	长机座
短机座	顶尾座	中间块

质量保证期满后，对设备进行维修，只收取成本费用。最短的时间内完成。

三、下列范围不属于免费保修服务范围：

我们的保修承诺只适用于最初的购买客户，保修期内正常使用情况下所引起的损坏，不包含消耗性的附件或任何由于使用不当、粗心操作、改造引起的损坏。

- 1、超过保修期的机器
- 2、未按产品使用说明的要求使用，维护、保管而造成损坏的。
- 3、自行改装过机器。
- 4、因不可抗力造成损坏的。

四、如何得到服务

当您需要维修服务时，将机床或部件打包退还我司或保修点。同时出示当时的购买凭证。我们会在最短的时间内完成。

相关信息填写表

若您是通过代理商购买产品，请提供该代理商的正确信息，多谢合作！

产品名称： _____ 销售日期： _____

经销商名称： _____ 经销商电话： _____

故障现象： _____

导致原因： _____

用户单位： _____ 姓名： _____ 联系电话： _____

收货地址： _____

Warranty Card

Dear Customer:

Thank you for choosing our products. Please read carefully and keep this warranty card safely.

1. This warranty card must be stamped with seal of the manufacturer or dealer.

2. List of parts under 1 year warranty.

Lead screw	Bearing	Headstock
Slide	Power switch	Machine bed, long
Machine bed, short	Tailstock	Intermediate connection piece

Charges will be applied for repairs and maintenance after expiry date.

3. This warranty excludes and does not cover defect, malfunctions or failures which were caused by repairs by persons not authorized by us, use of parts or accessories not authorized by us, mishandling, improper installation, modifications, or damage to the machine while in your possession, or unreasonable use.

4. Please pack the machine properly with the warranty card and mail it to our after-sale service department.

Customer Registration Form

If you purchased our products through an agent, please provide the information of the agency. Thank you for your cooperation!

Product Model Number / Name: _____

Purchase Date: _____

Name of agency: _____

Phone No. : _____

Malfunction: _____

Customer Name: _____

Customer Phone No. : _____

Customer Address: _____



地址：广东省佛山市顺德区国家高新开发区(容桂高黎)科苑一路3号

电话：0757-28386038 售后电话：18928655227

邮编：528305

网址：www.xendoll.com 邮箱：info@xendoll.com

Foshan Xendoll Intelligent Technology Co., Ltd.

Address: No.3 Keyuan Road, (Ronggui Gaoli), National High Tech Development Zone,
Shunde District, Foshan City, Guangdong Province, China

Phone: 0757-28386038 Post Code: 528305

Website: www.xendoll.com E-mail: info@xendoll.com



手机版网站



微信公众号



售后服务